

# BRASS CAPILLARY

## Winged Connector Spurred

### Product Specifications

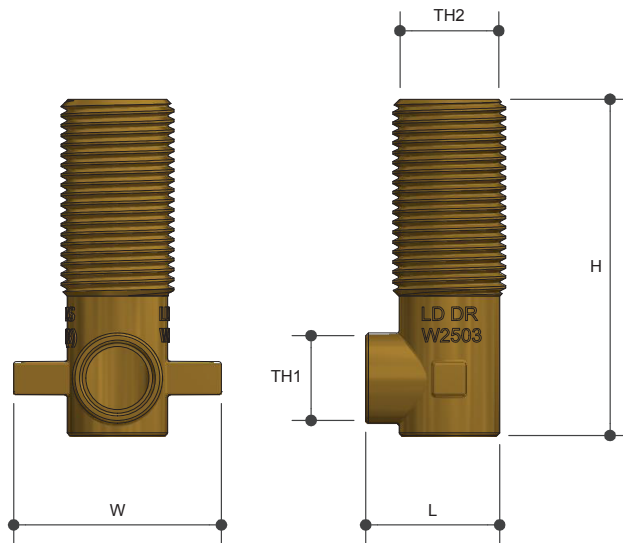

### Specifications

Working temperature 1°C - 99°C

Maximum pressure 1600kPa

### Sizing Chart (MM)

	L	H	W	TH1	TH2
AW002	25	62	38	15OD	G 1/2"

### Features

Watermark Approved

DR Brass

Tested and certified to AS 3688

### Material Chart

Part	Material
Connector	DR Brass

For more information on Metforge, contact:

Austworld 15 Activity Crescent, Molendinar, Queensland 4214 Australia

P. 1300 780 430

F. 1300 780 441

E. [info@austworld.com.au](mailto:info@austworld.com.au)

Austworld Pty Ltd. All rights reserved 2018. Austworld and Metforge are registered trade mark belonging to Austworld Pty Ltd.

