

SCREWED BRASSWARE

Adaptor MI X FI Extended

Product Specifications

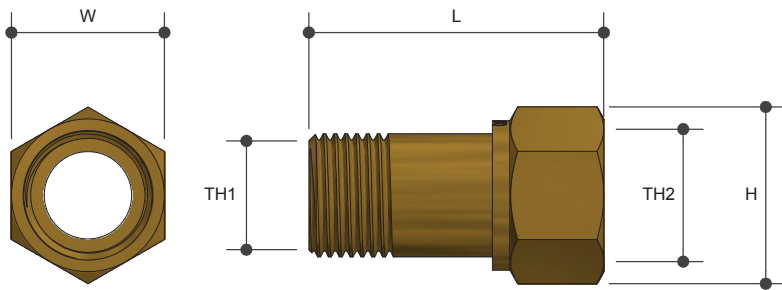

Specifications

Working temperature 1°C - 95°C

Maximum pressure rating 1600kPa

Sizing Chart (MM)

	L	H	W	TH1	TH2
AW4009	40	28	26	G 1/2"	Rp 1/2"
AW4009NB	40	28	26	G 1/2"	Rp 1/2"
AW4008*	40	29	26	G 1/2"	Rp 1/2"
AW4000	50	30	26	G 1/2"	Rp 1/2"
AW4000NB	50	30	26	G 1/2"	Rp 1/2"
AW4003*	50	30	26	G 1/2"	Rp 1/2"
AW4001	65	29	25	R 1/2"	Rp 1/2"
AW4001NB	65	29	25	R 1/2"	Rp 1/2"
AW4002*	65	28	26	R 1/2"	Rp 1/2"
AW4004	75	30	26	G 1/2"	Rp 1/2"
AW4005	75	28	26	R 1/2"	Rp 1/2"
AW4007	100	30	26	R 1/2"	Rp 1/2"
AW4006	100	30	26	R 1/2"	Rp 1/2"

* Chrome Plated

Features



Watermark approved

Brass and chrome finish

Tested and certified to AS 3688

Material Chart

Part	Material
Adaptor	DR Brass

For more information on Metforge, contact:

Austworld 15 Activity Crescent, Molendinar, Queensland 4214 Australia

P. 1300 780 430

F. 1300 780 441

E. info@austworld.com.au

Austworld Pty Ltd. All rights reserved 2018. Austworld and Metforge are registered trade mark belonging to Austworld Pty Ltd.

