

HOT WATER BOILING COMPONENTS

Brazing Connection MI X FI

Product Specifications

Metforge®
brassware

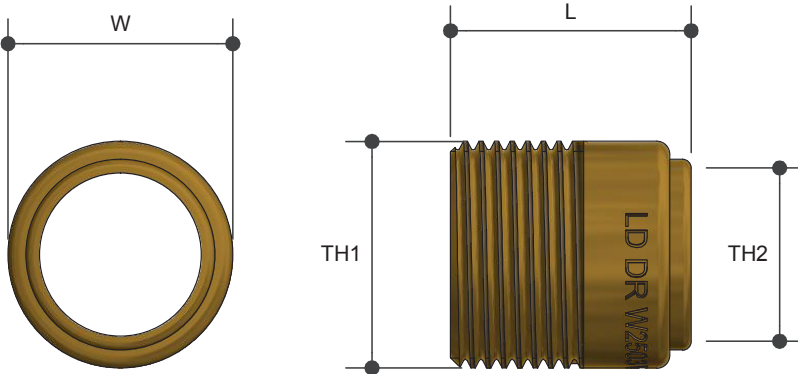

Specifications

Maximum working temperature 1°C to 60°C

Maximum pressure rating 1600kPa

Sizing Chart (MM)

	L	W	TH1	TH2
BR014	28	26	Rp 3/4"	22OD

Features



Watermark approved

DR Brass

Tested and certified to AS 3688

Material Chart

Part	Material
Connector	DR Brass

For more information on Metforge, contact:

Austworld 15 Activity Crescent, Molendinar, Queensland 4214 Australia

P. 1300 780 430

F. 1300 780 441

E. info@austworld.com.au

Austworld Pty Ltd. All rights reserved 2018. Austworld and Metforge are registered trade mark belonging to Austworld Pty Ltd.

AW
AUSTWORLD